

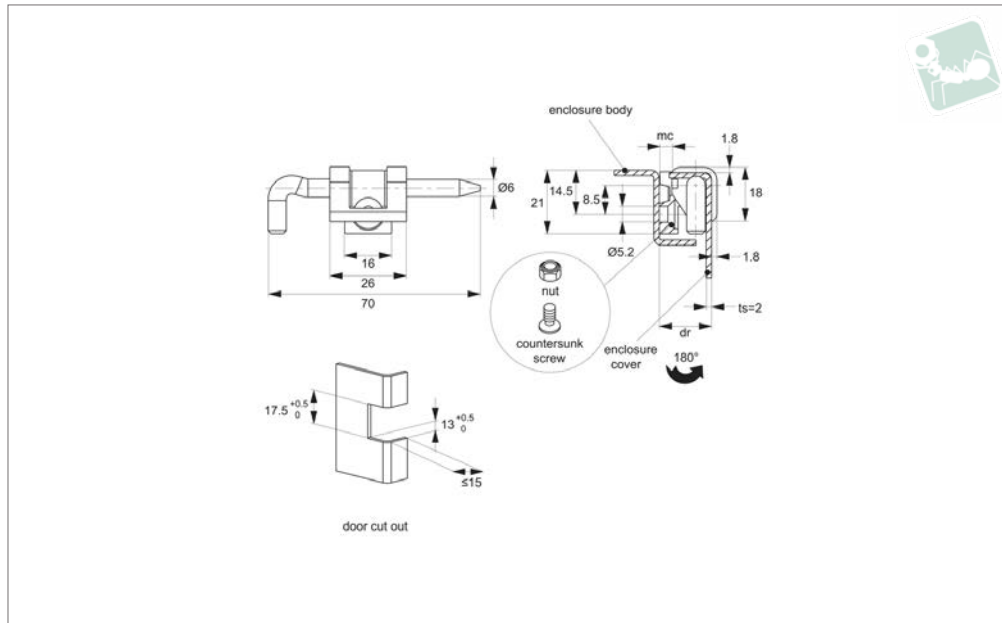

# Corner Hinge - 17mm Door Return cut out and countersunk screw - zinc

## Stays & Hinges



**HH0420**

STAYS & HINGES

### Material

Hinge: die cast zinc, black powder coated.  
Pin: stainless steel AISI 304.

### Technical Notes

For sheet metal and machine enclosures with a 17mm door return, upto 2mm thick.  
For installation dimension see cut out

### detail.

Universal left or right hand opening doors.  
Max. opening angle 180°.

### Tips

Mounting via M5 countersunk screws (not supplied).

### Important Notes

dr= Maximum door return suitable for use with hinge.

mc= Minimum clearance advised between enclosure cover and body to ensure smooth, full opening of enclosure cover.

Order No.	Finish	Door return	$F_x$ N	$F_y$ N	mc min.	ts panel thickness
HH0420.M0010	Black coated	17	405	805	2	2.0

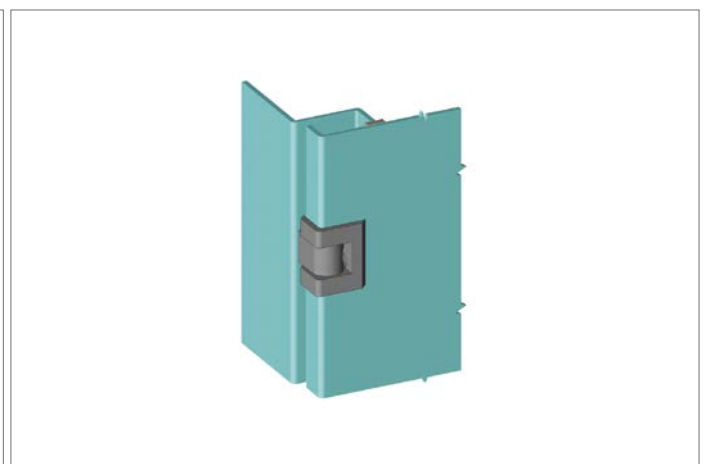
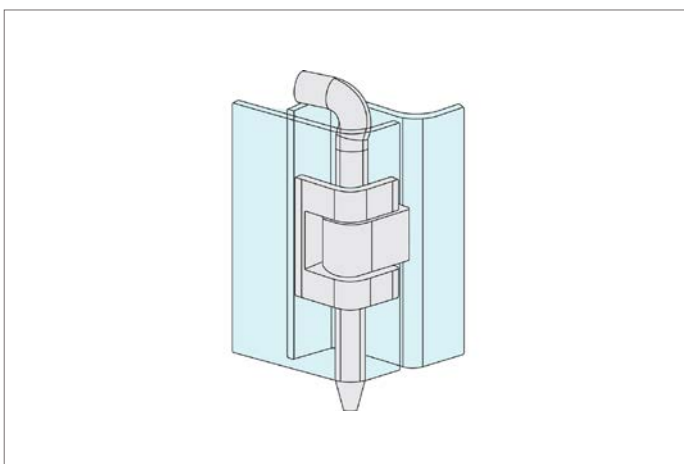



### A variety of mounting methods are available!

#### Mounting combinations

Wixroyd concealed hinges can be mounted in a variety of ways using additional nuts and bolts.

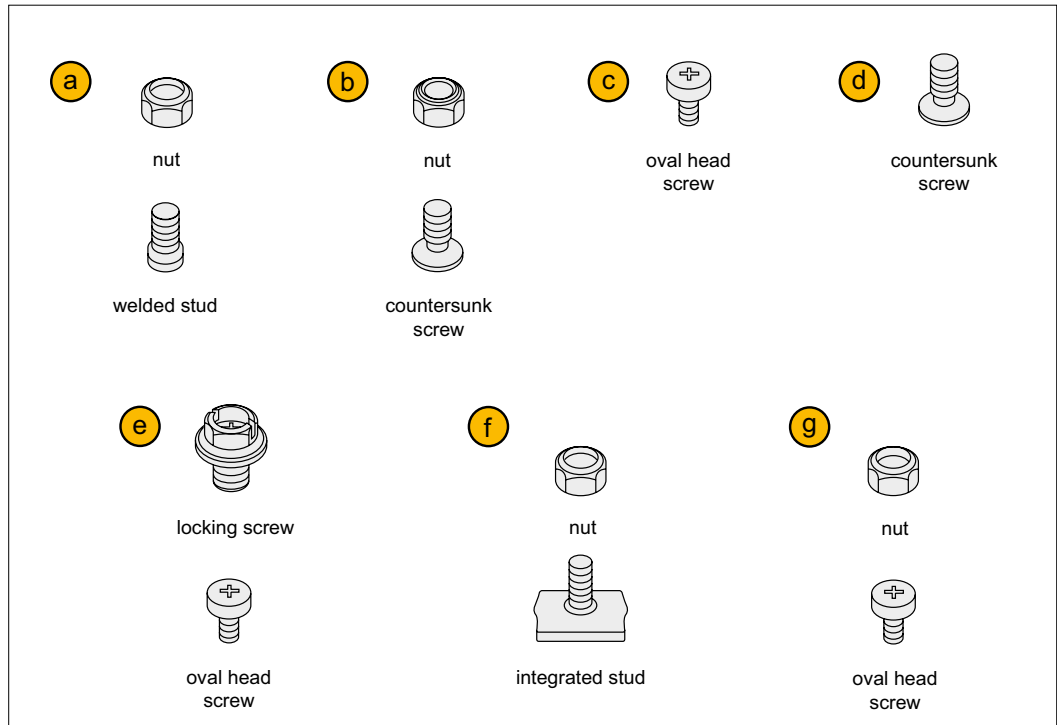

**Important Note:** Refer to individual product pages for suitable mounting options. If you have any problems please contact our Technical Sales Team.

#### Mounting example

In the example, mounting option ②, a nut with a countersunk screw, is used to mount the hinge onto the enclosure body.

